

# Verderlobe

## Rotary Lobe Pump Sterilobe



VERDERLOBE®

### Description

The rotary lobe pumps Verderlobe made by Wright Flow technologies are a proven classic. Since decades the Sterilobe pumps work reliable all around the globe. Sterilobe rotary lobe pumps are used in a wide range of applications in the food, dairy, pharma and petrochemical industries.

### Your benefits

- Improved CIP capability
- Easy maintenance due to front loaded seals
- Improved self draining
- Clean and corrosionresistant surface
- Wide range of o-ring and mechanical seals available
- Standard surface finish of 0,6 µm Ra
- Higher surface finish upon request
- FDA, 3A, EHEDG and Atex certified

### Technical Data

Max flow rate [m³/h]	230
Max differential pressure [bar]	15
Max viscosity [mPas]	110,000
Max temperature [°C]	150

### Rotors

Two different types of rotors are available: Bi-Wing and Multi-Lobe rotors are both suitable for temperatures up to 150 °C. These rotors are made of stainless steel AISI 316L as a standard. The Bi-Wing rotors are used for higher flow rates and higher viscosities. For shear sensitive liquids and lower pulsation the Multi Lobe rotors are used.

### Overview

Model	Max flow [l/rev]	Max differential pressure [bar]	Connections Ø [mm]	Max pump speed [rpm]
SLAS	0,039	15	19	1400
SLAL	0,059	10	25	1400
SLBS	0,081	15	25	1200
SLBL	0,122	10	38	1200
SLCS	0,169	15	38	1200
SLCL	0,254	10	50	1200
SLDS	0,352	15	38	1000
SLDL	0,528	10	50	1000

Model	Max flow [l/rev]	Max differential pressure [bar]	Connections Ø [mm]	Max pump speed [rpm]
SLES	0,732	15	50	800
SLEL	1,099	10	76	800
SLFS	1,524	15	76	600
SLFL	2,285	10	101	600
SLGS	2,170	15	101	600
SLGL	4,754	10	152	600
SLHS	6,400	15	152	600



# Verderlobe

## Rotary Lobe Pump Sterilobe



VERDERLOBE®

### Dimensions

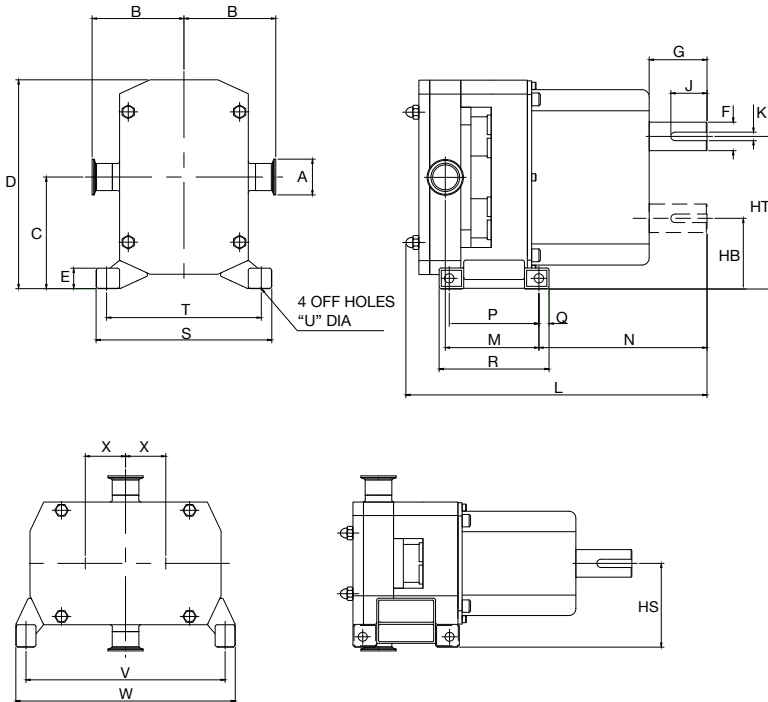

Model	A	B1	B2	B3	B4	B5	C	D	E	F	G	HB	HS	HT	J	K	L	M	N	P	Q	R	S	T	U	V	W	X
SLAS	19	69	83	-	97	97	87.5	158	22	14	25.5	60.5	74.5	115.5	20	5	235	84	118.5	62	11	84	149	128	9	156	176	27.5
SLAL	25	83	83	-	97	97	87.5	158	22	14	25.5	60.5	74.5	115.5	20	5	244	86	118.5	62	11	84	149	128	9	156	176	27.5
SLBS	25	101	101	115	115	115	101	185	22	20	35.5	67.5	85	135.5	35	6	300	85	174	62	11	84	170	149	9	182	202	34
SLBL	40	101	123	115	115	115	101	185	22	20	35.5	67.5	85	135.5	35	6	311	90	174	62	11	84	170	149	9	182	202	34
SLCS	40	107	129	121	121	121	129	233	30	24	46	86.5	101.5	171.5	30	8	332	123	162.5	124	14	152	203	173	13	228	257	42.5
SLCL	50	107	129	121	121	129	129	233	30	24	46	86.5	101.5	171.5	30	8	346	131	162.5	124	14	152	203	173	13	228	257	42.5
SLDS	40	127	139	131	131	131	156.5	294	29	40	80	99	121.5	214	50	12	417	129.5	232.5	124	14	152	243	214	13	284.5	313.5	57.5
SLDL	50	127	139	131	131	139	156.5	294	29	40	80	99	121.5	214	50	12	436	139.5	232.5	124	14	152	243	214	13	284.5	313.5	57.5
SLES	50	158	167	159	159	167	192.3	360	43	48	80	122	180	262	60	14	494	155	275.5	170	16	202	360	320	18	354	384	70
SLEL	80	158	167	159	167	172	192	360	43	48	80	122	180	262	60	14	518	167	275.5	170	16	202	360	320	18	354	384	70
SLFS	80	173	205	187	195	200	216	409	43	50	80	136	191	296	65	16	572	176.5	305	170	16	202	382	342	18	402	432	80
SLFL	100	177	220	187	195	200	216	409	43	50	80	136	191	296	65	16	606	191.5	305	170	16	202	382	342	18	402	432	80
SLGS	100	194	237	204	212	217	251	480	43	60	108	156	202	346	90	18	742	211	419	170	16	202	405	365	18	472	502	95
SLGL	150	194	237	204	212	217	251	480	43	60	108	156	202	346	90	18	795	237	419	170	16	202	405	365	18	472	502	95

h.: horizontal  
v.: vertical

Find your local supplier  
at [www.verderliquids.com](http://www.verderliquids.com)

For construction, installation and floor mounting drawings  
please contact your local authorised Verderlobe® distributor.

**VERDER**  
passion for pumps

