

Description

The VA-E25 is an electrical driven double diaphragm pump. With the wide range of different available materials for pump body, valve seats, valve balls and diaphragms, this pump is the ideal problem solver in a wide range of applications across many industries. The VA-E25 can run in “low pulsation mode” to reduce the generated pulsations in the flow or in “transfer mode” to generate a higher flow rate.



Your benefits

- Energy efficient
- Smoother flow when operating in “low pulsation mode”
- Low noise level
- Can stall against close discharge
- Can run dry without damage
- Dry self priming

Technical data	Drive option	Fluid & air section	
	NG	AA	69,5
		PA	67
		PS	98,5
		SA	85
		SS	116,5
	Weight [lb]	AC	Extra weight on the drive option NG above
AF		Extra weight on the drive option NG above	+ 40
A1		Extra weight on the drive option AC above	+ 28
Max. Suction lift (fwc)		Dry	16
		Wet	29
Temperature (°F)	A,S	Internals	
		AC,BN	10 180
		VT	-40 275*
		GE	-40 150
		NO,NE, NW	0 180
		PP	32 150
		TO	40 180
		TF	40 220
		SP	-40 180
		HY	-20 150
	P	All except TF,TO	32 150
		TF, TO	40 150



Drive option			
Electric Motor	AC,A1	Power (HP)	2
		Voltage (V)	3 x 230/460 - 60
	AF	Power (HP)	2
		Voltage (V)	3x 240/460 - 60
Max. Particle size (in)		1/8	
Air connection		3/8" NPT(f)	
Air consumption (scfh)		< 0.2	
Max. recommended viscosity (cP)		10.000	

Code VA-E25 No.1 No.2 No.3 No.4.No.5.No.6.No.7.		
<p>No.1 Fluid section A = Aluminium S = Stainless Steel P = Polypropylene</p> <p>No.2 Center section A = Aluminium S = Stainless Steel</p> <p>No.3 Check valve seats AC = Acetal AL = Aluminium BN = Buna-N GE = Geolast HY = Hytrel (TPE) PP = Polypropylene SP = Santoprene SS = Stainless Steel 316 VT = Viton (FKM)</p>	<p>No. 4 Check valve balls AC = Acetal BN = Buna-N GE = Geolast</p> <p>HY = Hytrel (TPE) NE = Neoprene NW = Neoprene Weighted SP = Santoprene SS = Stainless Steel 316 TF = PTFE VT = Viton (FKM)</p> <p>No. 5 Diaphragms BN = Buna-N GE = Geolast HY = Hytrel (TPE) NO = Neoprene overmolded SP = Santoprene</p>	<p>TF = PTFE/EPDM 2 piece TO = PTFE/EPDM overmolded VT = Viton (FKM)</p> <p>No. 6 Connections TB = Threaded BSP(f) TN = Threaded NPT(f) FC = Center Flange DIN/ANSI FE = End Flange DIN/ANSI</p> <p>No. 7 Drive options AC = Standard AC Induction motor with gearbox (184 rpm) *AF = Explosionproof AC Induction motor (159 rpm) NG = NEMA 56 C gearbox A1 = Standard AC Induction motor with compressor 120V</p>

EXAMPLE PUMP TYPE

VA-E25 AA HY AC HY TB AC

NOTE not all combinations are available

* UL listed - SA

Class1, Zone 1, Aex d IIB T3 32°F<T_a<104°F



Performance curve

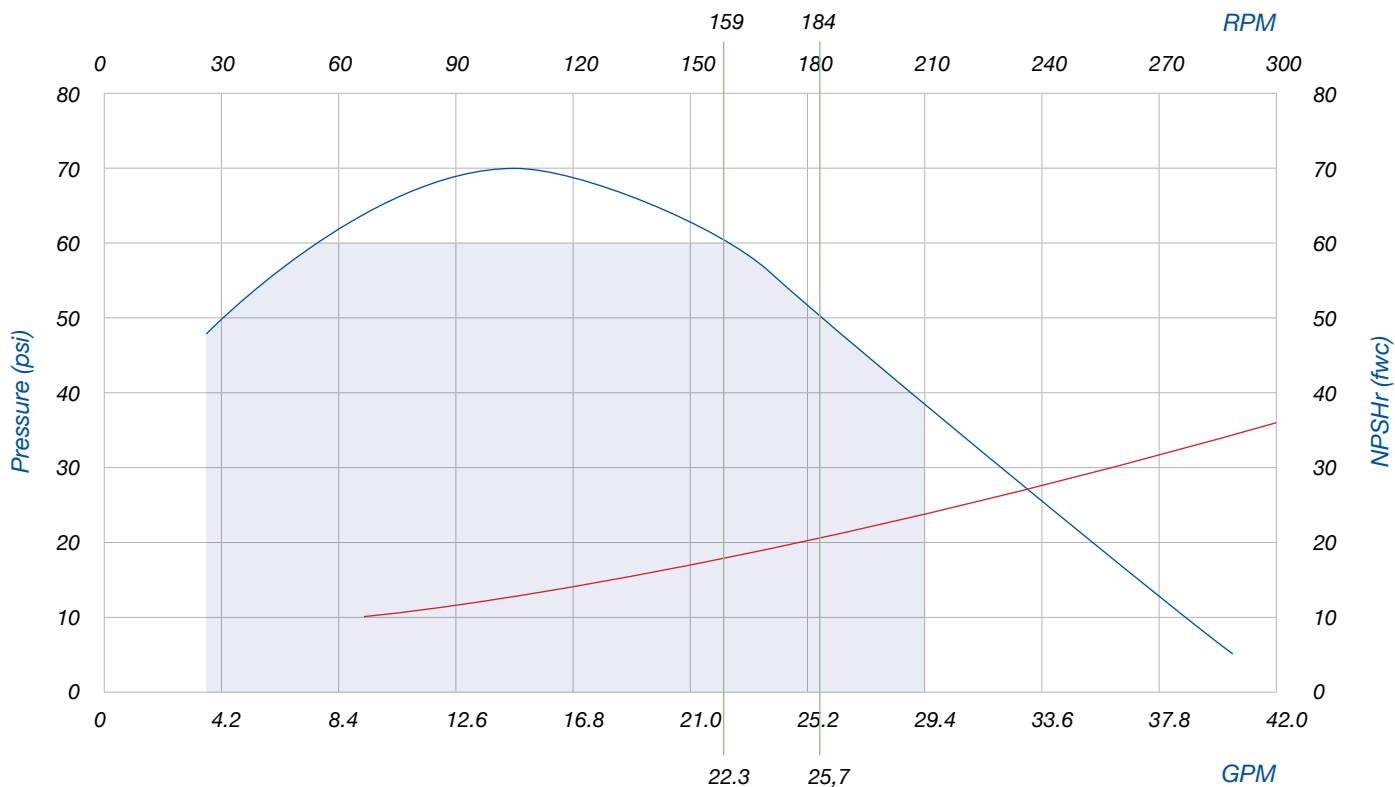

Dimensions (inch)

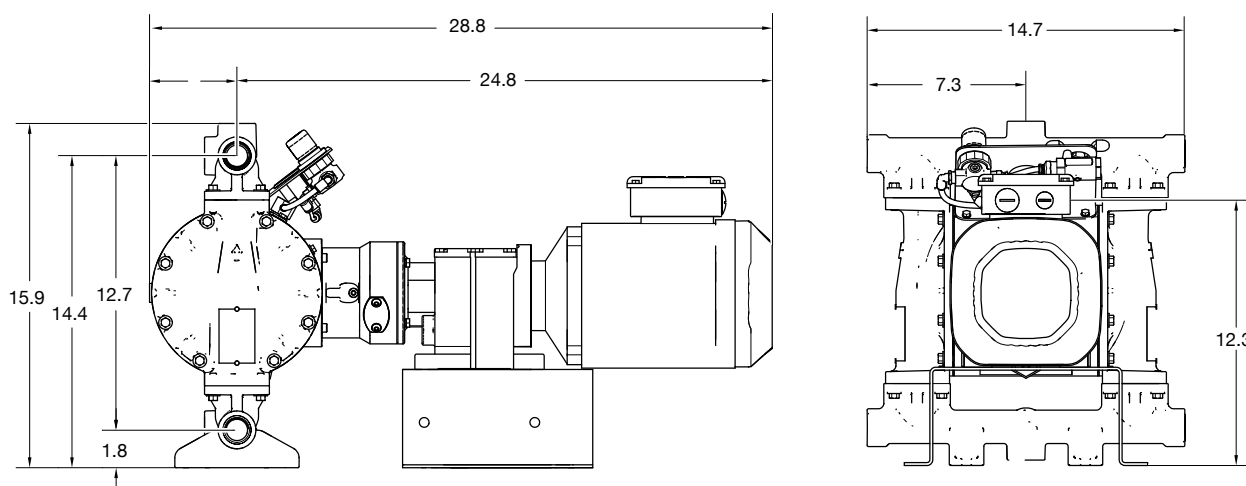

(Aluminium version with AC drive)



Find your local supplier at www.verderair.com

For construction, installation and floor mounting drawings please contact your local authorised Verderair® distributor.