

28520 Series

Hygienic Stainless Steel Head Kit Pump

Features

- Self primes from dry up to 4.5 metres
- Flows up to 365 litres per minute
- Pressure up to 2.5 bar†
- Handles soft solids - max. 16mm diameter
- Certified to US 3A Standard 02-09
- Clean-In-Place (CIP) or easy strip clean
- Handles viscosities up to 10,000 centiPoise
- Minimal shear to thixotropic fluids
- Fits IEC standard motor B3/B14, frame 100



Typical Applications

- Foods, sauces, doughs, preserves, liquid egg, meat pastes
- Dairy products, milk, cream, yoghurt, cheeses
- Cosmetics, toothpaste, shampoos, soaps
- Pharmaceutical creams & lotions
- Wines, beers, soft drinks, fruit juices & syrups
- Ingredients unloading and transfer
- Tank filling and emptying
- Recirculation and mixing
- Portion and container filling
- Brine injection
- Sampling, filtration and more

Specifications

Seal : Carbon / Ceramic mechanical face seal
Tungsten Carbide / Ceramic hard faced seal
Flushed options for crystallising fluids

Seal Elastomer : Food grade Nitrile

Pump Head : Stainless steel 316, machined interior and electropolished exterior finish

End Cover : Stainless steel 316 grade

Shaft : Stainless steel 316 grade shaft extension

Bearings : Uses motor bearings

Motor Adaptor : Epoxy coated cast iron

Ports :	2"	Tri-Clamp	28520-1xxx
	38mm	IDF/ISS	28520-3xxx
	2"	RJT to BS1864	28520-4xxx
	2"	3A Bevel Seat	28520-5xxx
	40mm	DIN 11851	28520-6xxx
	38mm	SMS 1145	28520-7xxx

Model Range

Weight : 10.0kg

Pressure options	Standard - Max 2.5 bar†		Medium - Max 2.5 bar†	
Elastomer option	3A Neoprene	E.P.D.M.	3A Neoprene	E.P.D.M.
Temperature range	4°C to 65°C	0°C to 120°C	4°C to 65°C	0°C to 120°C
Mechanical Seal Options				
Carbon/Ceramic	28520-x105			28520-x112
Tungsten Carbide/Ceramic hard faced				
Flushed Mechanical Seal				
Tungsten Carbide/Ceramic hard faced				
Carbon/Ceramic				
For models not listed above, consult distributor or factory, 'x' Substitute port code from table above				
Note : it is not recommended to start the pump at extremes of the temperature range, impeller damage may occur				
For Installation, Operating, Maintenance and Safety Instructions refer to form 43001-0543				



WARNING Explosion hazard. Do not pump gasoline, solvents, thinners or other flammable liquids. To do so can cause an explosion resulting in injury or death.

† Pressures over 1.0 bar may reduce motor shaft life

Fits IEC motor with foot & face to IEC B3/B14 frame size 100

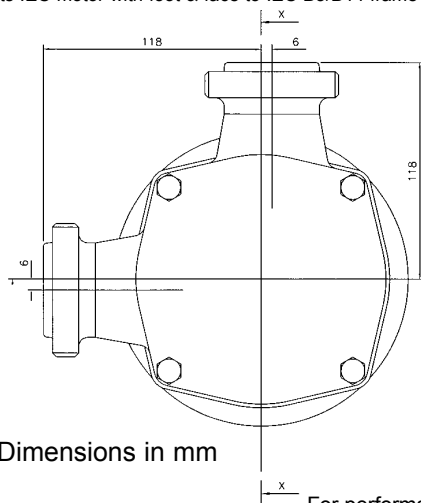

Dimensions in mm

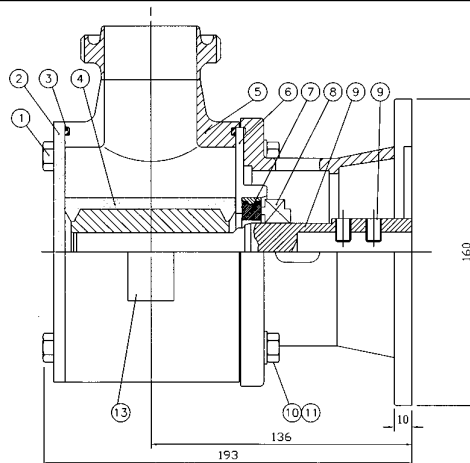

HALF SECTION X - X

For performance data refer to the 370 size flexible impeller pump performance curves

28520 Series

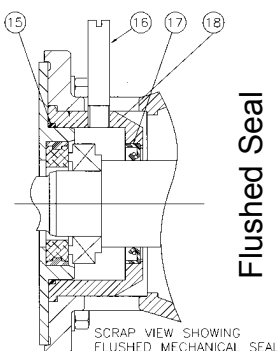

Flushed Seal

Parts List

Key	Description	Qty	Part Number
1	Screw	4	X3001-207F
2	Endcover	1	28505-0020
3	O'Ring *	2	See right
4	Impeller*	1	See right
5	Body	1	See right
6	Wearplate	1	28536-0000
7 / 8	Seal Assembly *	1	See right
9	Shaft Extension	1	28527-0001
10	Motor Adaptor	1	28523-0000
11	Screw	4	X3001-209F
12	Washer	4	X3080-101K
13	Screw	4	X3001-211F
14	Washer	4	X3080-101F
15	Set Screw	2	X3009-207A
22	O-Ring	1	X4020-269A
23	Seal Housing	1	28512-0000
24	Tube	2	21844
25	Seal	1	SP2701-0916

Parts marked * Contained in service kit

Spare Parts & Service Kits

Pressure Rating			Standard	Medium
3	O-Ring	Nitrile	X4020-424A	X4020-424A
4	Impeller	3A Neoprene	8984-0005B	8963-0005B
		E.P.D.M.		8963-0002B
5	Body	Tri-Clamp	28504-1000	28504-1000
		IDF/ISS	28504-3000	28504-3000
		RJT	28504-4000	28504-4000
		Bevel Seat	28504-5000	28504-5000
		DIN	28504-6000	28504-6000
		SMS	28504-7000	28504-7000
7 / 8	Seals	Std Mech.	28531-0103B	28531-0103B
		Hard Faced	28531-0203B	28531-0203B
Service Kit		3A Neoprene	SK379-0105	SK379-0115
		E.P.D.M.		
Models with Neoprene and E.P.D.M. impellers use Nitrile elastomers on seals and O-rings.				
NOTE:- Service Kits contain standard mechanical seals. For hard faced seals, order parts separately.				

Models with Neoprene and E.P.D.M. impellers use Nitrile elastomers on seals and O-rings.

NOTE:- Service Kits contain standard mechanical seals. For hard faced seals, order parts separately.

Other Available Options

Pedestal pumps, for higher pressure capability.