

JEC

Circumferential piston pumps JRZP



Description

Each feature of the JRZL rotary lobe pump has been designed to make pump disassembly faster, easier and cheaper. In this way cleaning and maintenance is done in the most efficient way. In addition: the forward directed seal position brings the seals into direct contact with CIP fluids.

Your benefits

- Excellent “easy to clean” seals
- The seal position prevents product trapping
- Two shaft keys on the rotors enable quiet operation under high pressure or vibration
- Better lubrication because of oil bath, instead of a grease lubrication
- Certified according to 3A and EHEDG

Technical details

Max. flow	1535 l/min	Max. viscosity	1.000.000 mPas
Max. pressure	15 bar	Temperature range	-10 to +180 °C
Max. rotation speed	800 rpm	Surface finish	Ra 0,6 µm (optional 0,4 µm)
Connections	DIN, ISO, Tri-Clamp, SMS, RJT, Flange	Certifications	3A, EHEDG, FDA, EC 1935/2004, ATEX

Summary

Model	Flow/rpm min-1	Standard connection (mm)	Max. pressure (bar)	Max. rotation speed (rpm)
ZP015-0063-15	0,063	38	15	800
ZP030-026-10	0,26	50	10	700
ZP060-074-15	0,74	63	15	600
ZP130-118-08	1,18	76	8	600
ZP220-204-12	2,04	100	12	500
ZP320-307-08	3,07	150	8	500

JEC

Circumferential piston pumps JRZP

Curve

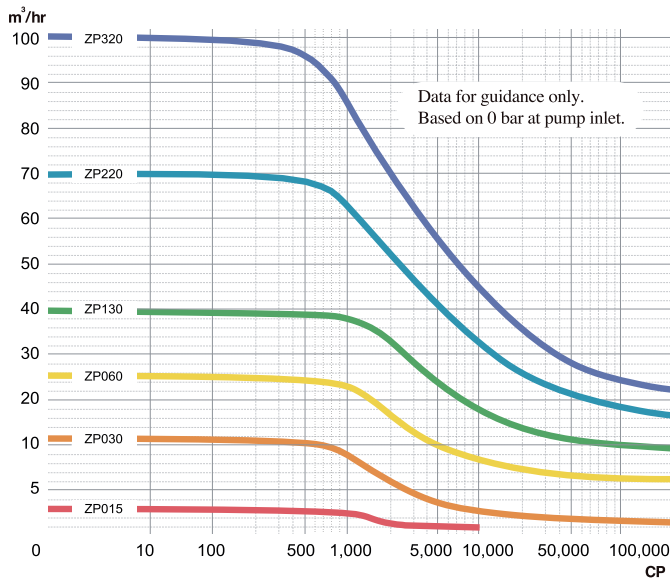

Dimensions

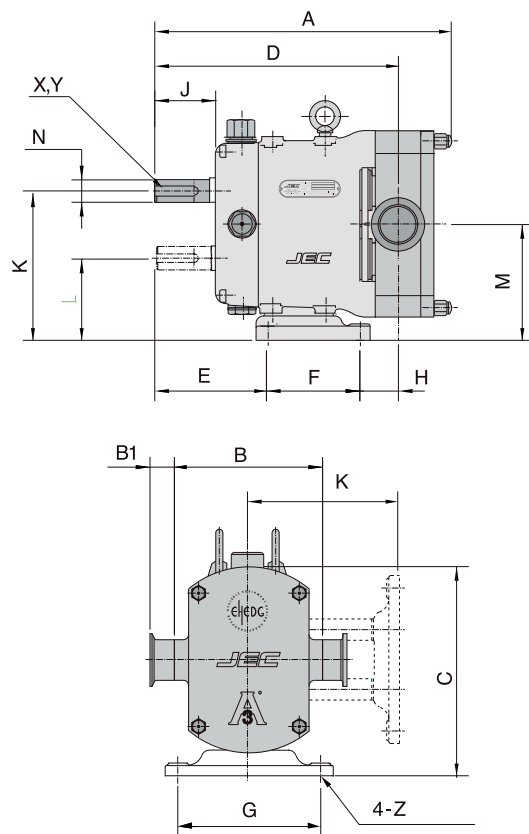

Model	Connections	Dimensions in mm															
		A	B	C	D	E	F	G	H	J	K	L	M	N	X	Y	Z
ZP015-0063-15	1½"	281	152	222	228	105	84	134	39	55	141	77	109	22	34	8	9
ZP030-026-10	2"	372	188	264,5	305	129	132	180	44	60	185	101	143	32	52	10	12
ZP060-074-15	2½"	471	242	347,5	380	158	160	242	67	68	243,5	128,5	186	45	57	14	13
ZP130-118-08	3"	497	242	347,5	393	158	160	242	80	68	243,5	128,5	186	45	57	14	13
ZP220-204-12	4"	631	324	458	504	498	210	320	97	80	324	170	247	55	67	14	15
ZP320-307-08	6"	666	324	458	522	498	210	320	114	80	324	170	247	55	67	14	15

All dimensions in mm (dimensions are approximate values)

Find your local supplier at www.verderliquids.com

For construction, installation and floor mounting drawings please contact your local authorised distributor.

VERDER
passion for pumps

