

# Torque Instructions

859.0247

## VERDERAIR VA 80 Diaphragm Pumps

Rev. B  
EN



### Important Safety Instructions

Read all warnings and instructions in the *VERDERAIR VA 80 Air-Operated Diaphragm Pump Repair/Parts manual*. Save all instructions.

**NOTE:** Fluid cover and manifold fasteners on the polypropylene pumps have a thread-locking adhesive patch applied to the threads. If this patch is excessively worn, the fasteners may loosen during operation. Replace screws with new ones or apply medium-strength (blue) Loctite or equivalent to the threads.

**NOTE:** Always completely torque fluid covers, then torque the manifold pieces together, then torque the assembled manifolds to the fluid covers.

Start all fluid cover screws a few turns. Then turn down each screw just until head contacts cover. Then turn each screw by 1/2 turn or less working in a crisscross pattern to specified torque. Repeat for manifolds.

### Fluid cover fasteners:

**Polypropylene and Stainless Steel:** 40-45 ft-lb (54-61 N•m)

**Aluminum:** 55-60 ft-lb (75-81 N•m)

### Manifold fasteners:

**Polypropylene:** 40-45 ft-lb (54-61 N•m)

### Aluminum:

**Refs 1-8:** 11-21 ft-lb (15-28 N•m)

**Refs 9-16:** 55-60 ft-lb (75-81 N•m)

### Stainless Steel:

**Refs 1-4:** 110-120 in-lb (12-13 N•m)

**Refs 5-12:** 40-45 ft-lb (54-61 N•m)

Retorque the air valve fasteners in a crisscross pattern to specified torque.

### Air Valve fasteners

**Plastic Center Sections:** 45-55 in-lb (5-6.2 N•m)

**Aluminum Center Sections:** 75-85 in-lb (8.5-9.6 N•m)

Also check and tighten the nuts or bolts (X) holding the manifold feet to the mounting brackets.

Fluid Cover Screws

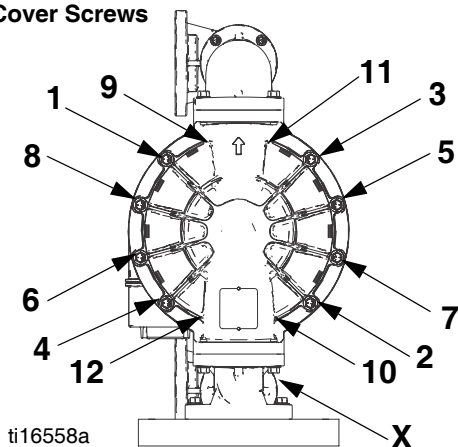

Air Valve Screws

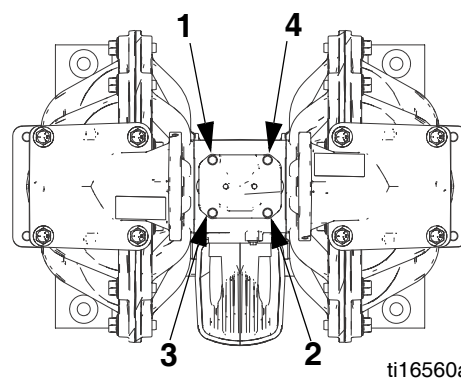

See reverse for manifold fasteners.

Aluminum

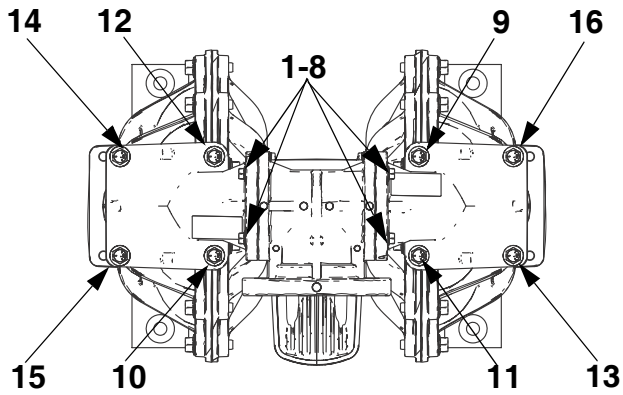

ti16559a

Polypropylene

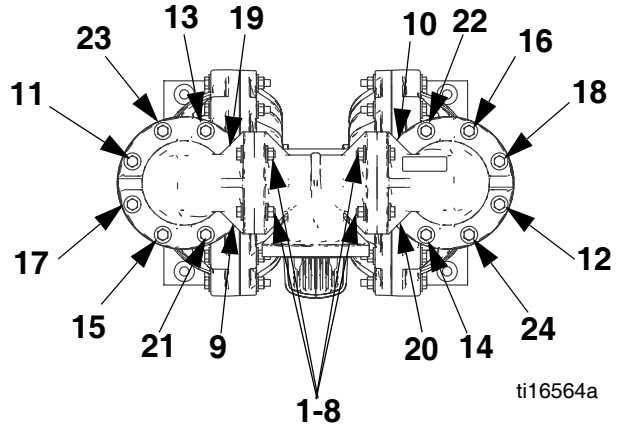

ti16564a

Stainless Steel

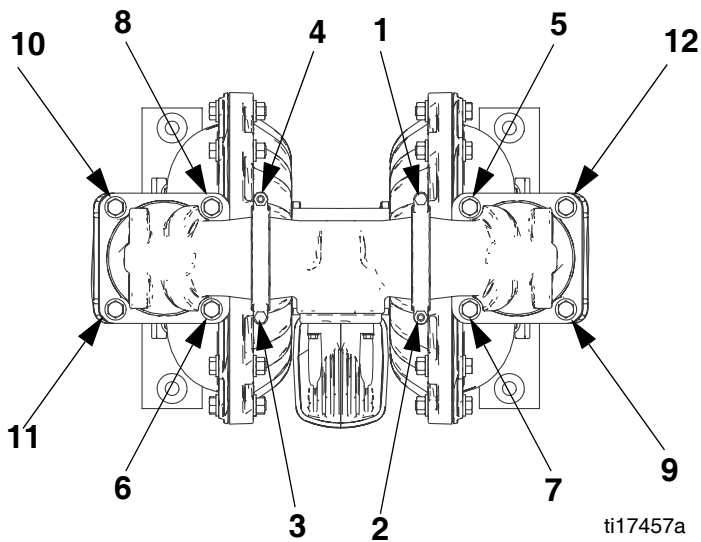

ti17457a

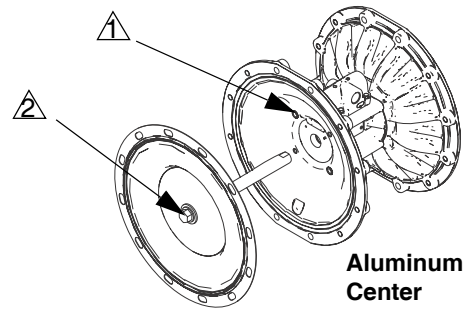

Aluminum Center

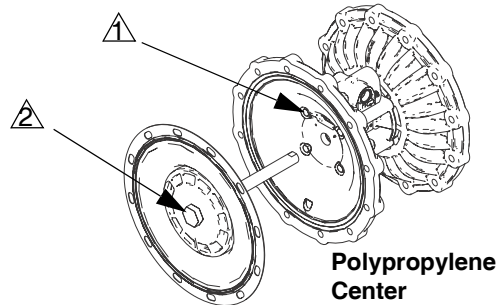

Polypropylene Center

△ Aluminum: Torque to 30-40 ft-lb. (41-54 N•m).  
 Poly: Torque to 25-35 ft-lb. (34-47 N•m).

△ Torque to 110-120 ft-lb. (149-163 N•m) at 100 rpm maximum.